



IN COOPERATION WITH
AMERICAN SOCIETY OF HOME INSPECTORS



★★ PRESENTS ★★
**INSPECTION
WORLD 2024**
★ ON THE ROAD IN ST. LOUIS ★
SEPTEMBER 20TH & 21ST

SPONSORSHIP OPPORTUNITIES

Sponsorship raises your company above the crowd. St. Louis ASHI is offering a range of targeted sponsorship opportunities to reinforce your marketing efforts.



Lanyards (\$750)

Make sure your logo is in the hands of every attendee as the official sponsor of the conference lanyards.



Exhibitor (Varied Pricing)

Claim your on-site footprint to interact directly with engaged home inspectors.



Welcome Reception

Help us entertain attendees on Thursday night as the official sponsor of the Welcome Reception.

- **Inquire about pricing!**



Happy Hour Sponsor

Help us entertain attendees on Friday Night as an official sponsor.

- **Inquire about pricing!**
 - A. *Food Sponsorship*
 - B. *Beverage Sponsorship*



Coffee/Break Sponsor (\$500)

Help our attendees with a full day of incredible content as an official coffee/break sponsor.



Afternoon Snack (\$700)

Help us reenergize attendees with an afternoon snack as an official afternoon snack sponsor.



Head Shot Booth (\$2,500)

Sponsor the headshot booth. Everyone needs a new professional headshot. (For more details).

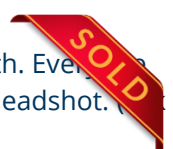

Want to do something special with your booth? Let us know, and we will do our best to accommodate you.

Do you have an idea for sponsorship but do not see it listed? Create your own!



**INSPECTION
WORLD 2024**
★ ON THE ROAD IN ST. LOUIS ★
SEPTEMBER 20TH & 21ST

If you choose one of the sponsorship opportunities, this is what you get

	Lanyards	Coffee Break	Welcome Reception	Happy Hour	Snack	Headshot Booth	1 Table Exhibitor	2 Table Exhibitor	3 Table Exhibitor
Booth/Table Location	You choose	You choose	Prime Location	Prime Location	You choose	You choose	You choose	You choose	You choose
Table Space Included	-----	-----	1 Table	1 Table	-----	1 Table	1 Tables	2 Tables	3 Tables
Staff Included	-----	-----	3	3	-----	2	2	4	6

Booth/Table location based on availability!

What Branding/Marketing Opportunities you get

	Lanyards	Coffee Break	Welcome Reception	Happy Hour	Snack	Headshot Booth	1 Table Exhibitor	2 Table Exhibitor	3 Table Exhibitor
Logo on event page	✓	✓	✓	✓	✓	✓	✓	✓	✓
Listed in the <i>Save the date email</i>			✓	✓		✓			
Listing in the <i>General marketing event emails</i>	✓	✓	✓	✓	✓	✓			
Included in <i>Special Conference Updates</i>			✓	✓		✓			
Included in <i>Know Before You Go email</i>	✓	✓	✓	✓	✓	✓			
Network with home inspectors	✓	✓	✓	✓	✓	✓	✓	✓	✓

All exhibitors and sponsors are subject to the approval of the St. Louis ASHI chapter.



INSPECTION WORLD 2024

★ ON THE ROAD IN ST. LOUIS ★
SEPTEMBER 20TH & 21ST

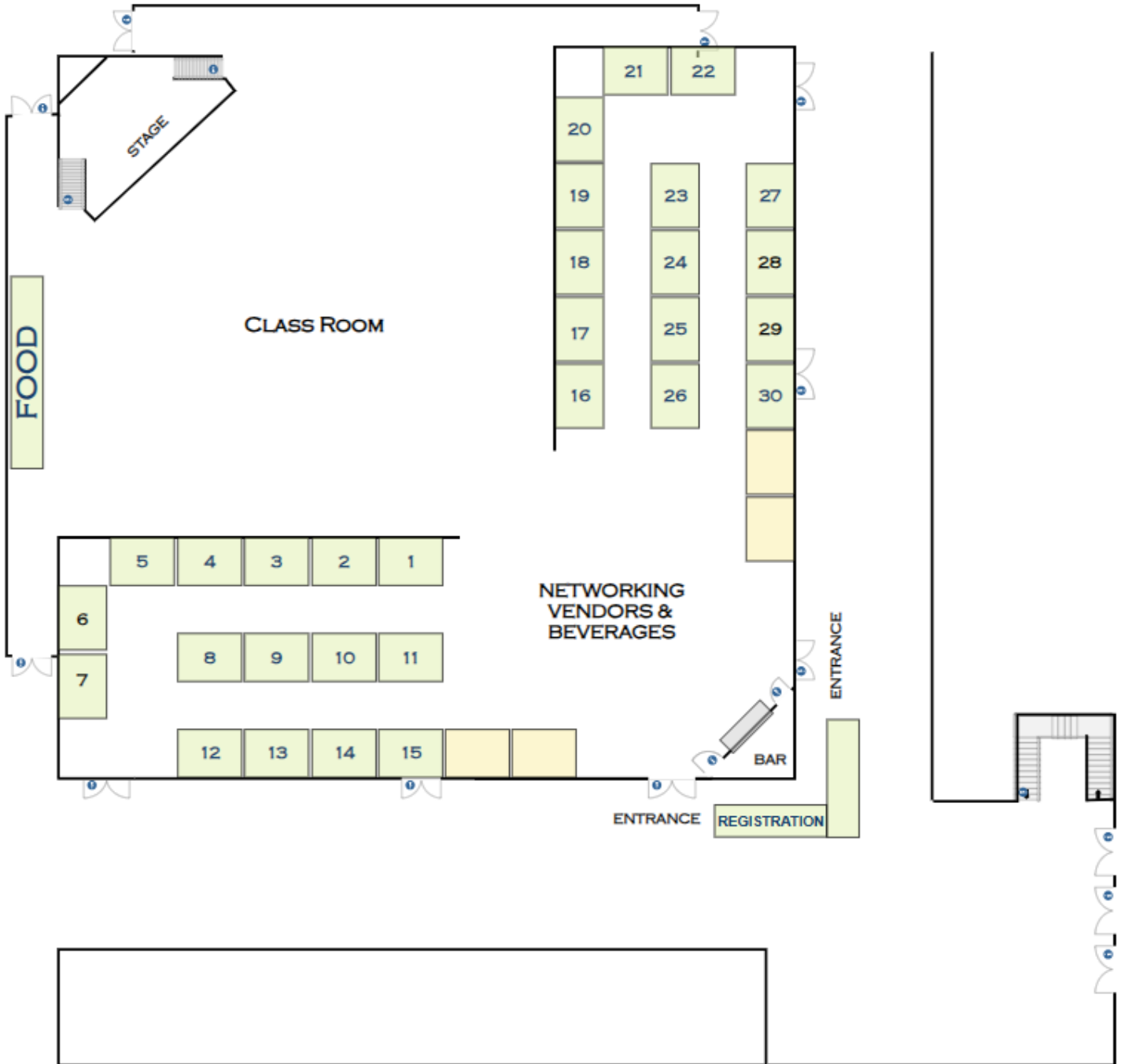



**INSPECTION
WORLD 2024**
★ ON THE ROAD IN ST. LOUIS ★
SEPTEMBER 20TH & 21ST

SPONSOR AND EXHIBITOR APPLICATION

Company Name: _____

Full Name: _____

Title: _____

Address: _____

City/State: _____ Zip: _____

Email: _____ Phone: _____

Marketing Opportunities

- Welcome Reception (\$ ask!)**
- Happy Hour (\$ ask!)**
- Lanyards (\$1,000)**
- Headshot Booth (\$2,500)**
- Coffee/Break (\$xxx)**
- Afternoon Snack (\$xxx)**
- Exhibitor - 1 Table (\$300)**
- Exhibitor - 2 Tables (\$550)**
- Price Not Listed (email -> education@stlashi.org)**

Payment

- Visa Mastercard Discover Amex

Card number: _____ Expr. Date _____ CW _____

Name on Card: _____

Billing Address: _____

City/State: _____ Zip: _____

Signature: _____ Date: _____

**All Cancellations must be made in writing. Full refunds will be granted until August 29, 2024, at 5:00 p.m. CST). A fifty percent (50%) refund will be granted until August 29, 2024, at 5:00 p.m. (CST). No refunds or credits toward future conferences will be granted after August 29, 2024. Confirmed attendees or exhibitors who do not attend the Conference will not be issued refunds or credit towards future conferences. There will be a 6% processing fee for ANY credit card refunds.*

Inspection World on the Road - St. Louis
Presented by St. Louis ASHI Chapter
September 20th & 21st
info@stlashi.org